

# DK48-A

## KAPLİN

## COUPLING

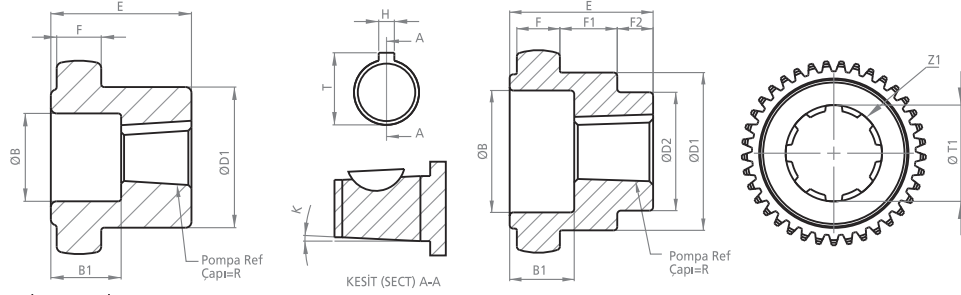

### POMPA MİLİNE GÖRE İŞLENMİŞ KAPLİNLER PROCESSED COUPLINGS PUMP SHAFT

KOD CODE	B	B1	D1	D2	E	F	F1	F2	H	K	R	T	T1	Z	Z1
DK48-1P03A	48	25	68	35	47	14	20	9	4.00	1/8	16.66	18.66	-	50	-
DK48-1P03TA	48	25	68	35	47	14	20	9	3.20	1/8	16.66	18.26	-	50	-
DK482PK03A	47	20	68	-	47	14	-	-	4.00	1/8	21.59	23.60	-	50	-
DK482PD03A	-	-	68	-	47	14	-	-	6.35	-	22.15	25.35	-	50	-
DK48-SAE-A-03A	-	-	68	-	47	14	-	-	5.00	-	19.05	21.55	-	50	-
DK483PDA	-	-	68	-	47	14	-	-	8.00	-	31.75	35.75	-	50	-
DK4813F-03A	-	-	68	-	47	14	-	-	-	-	-	-	21.80	50	13
DK4813F-1-03A	-	-	68	-	47	14	-	-	-	-	-	-	22.00	50	13
DK4815F-03A	-	-	68	-	47	14	-	-	-	-	-	-	25.20	50	15
DK4814F-1-03A	-	-	68	-	47	14	-	-	-	-	-	-	29.85	50	14
DK4814F-2-03A	-	-	68	-	47	14	-	-	-	-	-	-	30.00	50	14
DK4814F-3-03A	-	-	68	-	47	14	-	-	-	-	-	-	31.70	50	14
DK4814F-4-03A	-	-	68	-	47	14	-	-	-	-	-	-	27.25	50	14
DK488F-03A	-	-	68	-	47	14	-	-	-	-	-	-	36.10	50	8
DK4818F-03A	-	-	68	-	47	14	-	-	-	-	-	-	39.70	50	18



KOD CODE	A	A1	C	D	G	Z
DK4802A	99	79	48	67	10	50

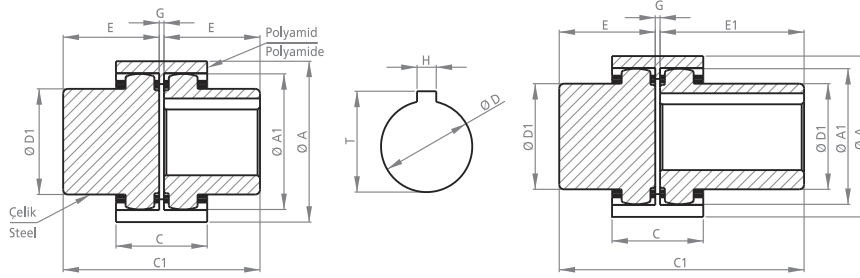
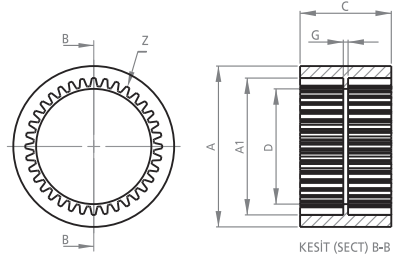

### MOTOR MİLİNE GÖRE İŞLENMİŞ KAPLİNLER PROCESSED COUPLINGS MOTOR SHAFT

KOD CODE	A	A1	C	C1	D	D1	E	E1	G	H	T	Z
DK4803A	99	77.25	48	96	-	68	47	-	2	-	-	50
DK481903A	99	77.25	48	96	19	68	47	-	2	6	22	50
DK482403A	99	77.25	48	96	24	68	47	-	2	8	28	50
DK482803A	99	77.25	48	96	28	68	47	-	2	8	32	50
DK483803A	99	77.25	48	96	38	68	47	-	2	10	43	50
DK484203A	99	77.25	48	96	42	68	47	-	2	12	47	50
DK484803A	99	77.25	48	96	48	68	47	-	2	14	53	50
UDK4803A	99	77.25	48	116	-	68	47	67	2	-	-	50
UDK482803A	99	77.25	48	116	28	68	47	67	2	8	32	50
UDK483803A	99	77.25	48	116	38	68	47	67	2	10	43	50
UDK484203A	99	77.25	48	116	42	68	47	67	2	12	47	50
UDK484803A	99	77.25	48	116	48	68	47	67	2	14	53	50

Motor Mil Çapları için  
sayfa 26'ya bakınız.  
Look at the paper 26 for  
Motor Shaft Diameters.

TOLERANSLAR MİL ÖLÇÜLERİNDE: -0 +0.05, DİĞER ÖLÇÜLERDE: ±0.15  
TOLERANCES SHAFT DIMENSIONS: -0 +0.05, OTHER DIMENSIONS: ±0.15  
Tasarım Tescil No Design Registration Certificate Number: 2001 01950